

# SECȚIUNE C-C

Sc. 1:20

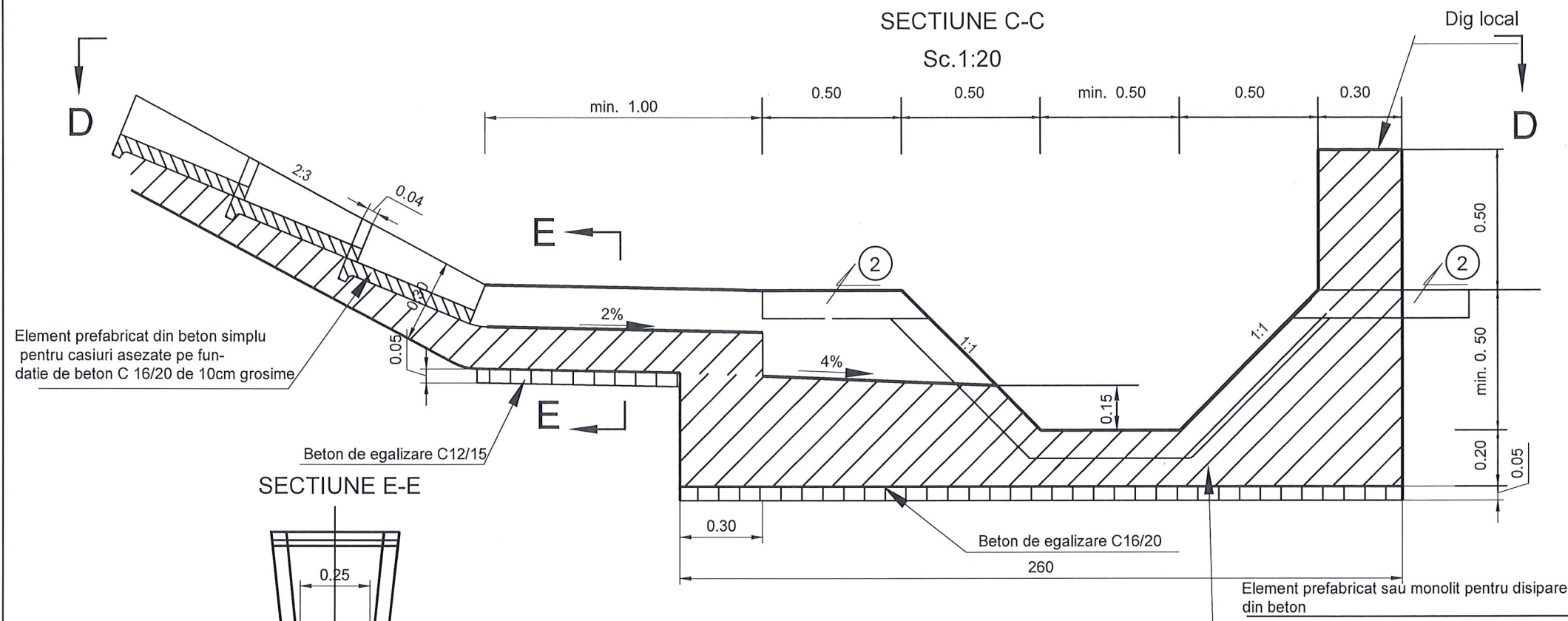

# SECȚIUNE E-E

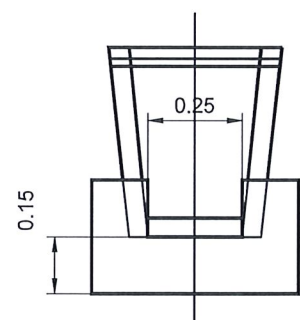

# VEDERE D-D

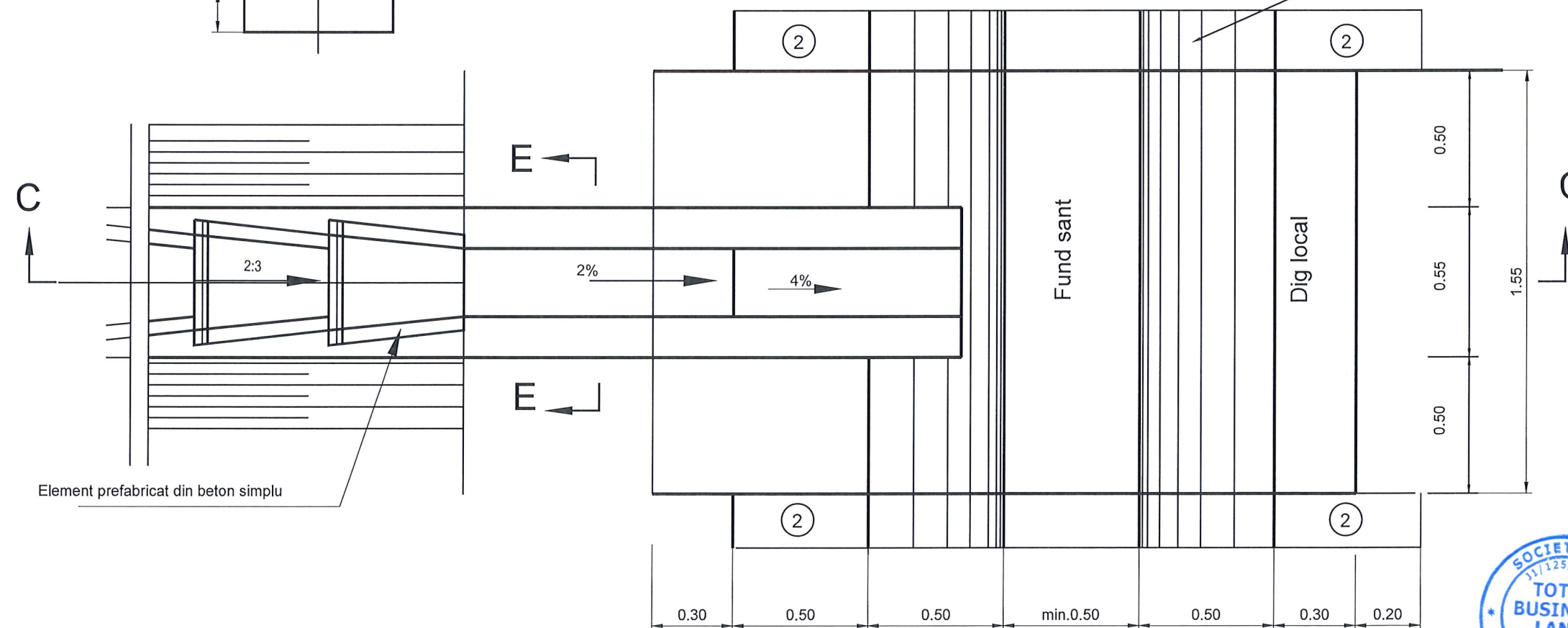

RACORDARE INTRE  
CASIUL PE  
TALUZ SI SANTUL  
DE LA BAZA  
RAMBLEULUI

Nr. crt.	Tip dispozitiv scurgerea apelor	Clasa de rezistenta	Clasa de expunere	Raport maxim apa/ciment	Dozaj minim de ciment (kg/mc)	Tip ciment
1	Rigola de acostament	C 30/37	XF4	0.55	340	CEM II ALL 42.5R
2	Sant trapezoidal	C 25/30	XF3	0.50	300	CEM II ALL 42.5R



Proiectant general:

S.C. TOTAL BUSINESS LAND S.R.L.

Nr.ord.reg.com. J01/125/2015 C.U.I. RO34090016  
ALBA IULIA, str. Brindusei nr. 24, Birou 1, jud. ALBA

CERTIFICAT  
SISTEM DE MANAGEMENT CALITATE  
ISO 9001:2015  
nr.09/NAT398  
ISO 14001:2015  
nr.14/NAT398  
SR OHSAS 18001:2008  
nr.18/NAT398

Specificatie

Manager de proiect :

Sef de proiect :

Proiectant:

Nume

Ing. Dumitruș Florian

dr.Ing. Radu E.E. Luca

Ing. Dumitruș Florian

Ing. Marin Răzvan

Ing. Simona Riciu

Semnatura

[Signature]

[Signature]

[Signature]

[Signature]

[Signature]

Scara:

1:20

Data:

2022

Beneficiar:

MUNICIPIUL SEBES

Titlu proiect:

„Drum de ocolire in partea de vest a Municipiului Sebes”

Titlu planșă:

DISPOZITIVE DE SCURGERE A APELOR

Proiect nr.

62/20.04.2022

Faza:

S.F.

Planșa nr.

DE.01-1



## RACORDARE INTRE RIGOLA DE ACOSTAMENT SI CASIUL DE PE TALUZ

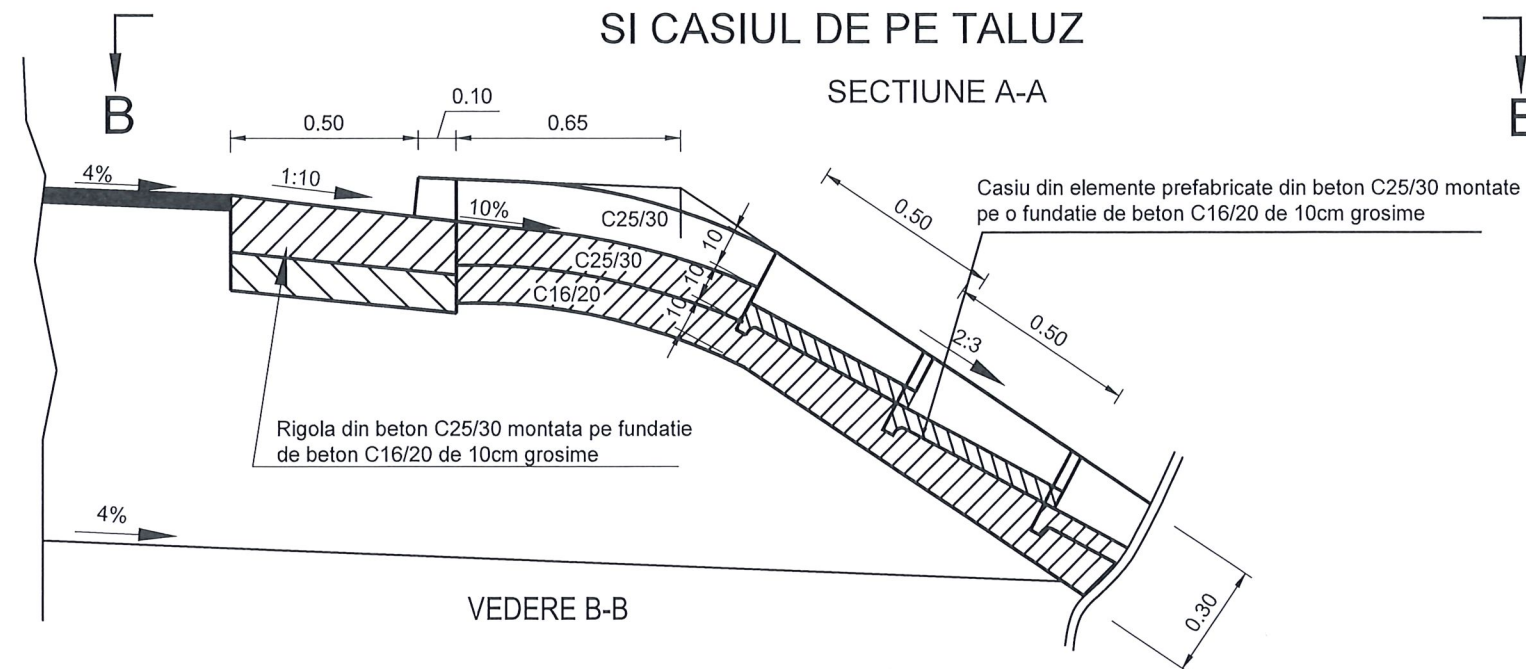

VEDERE B-B

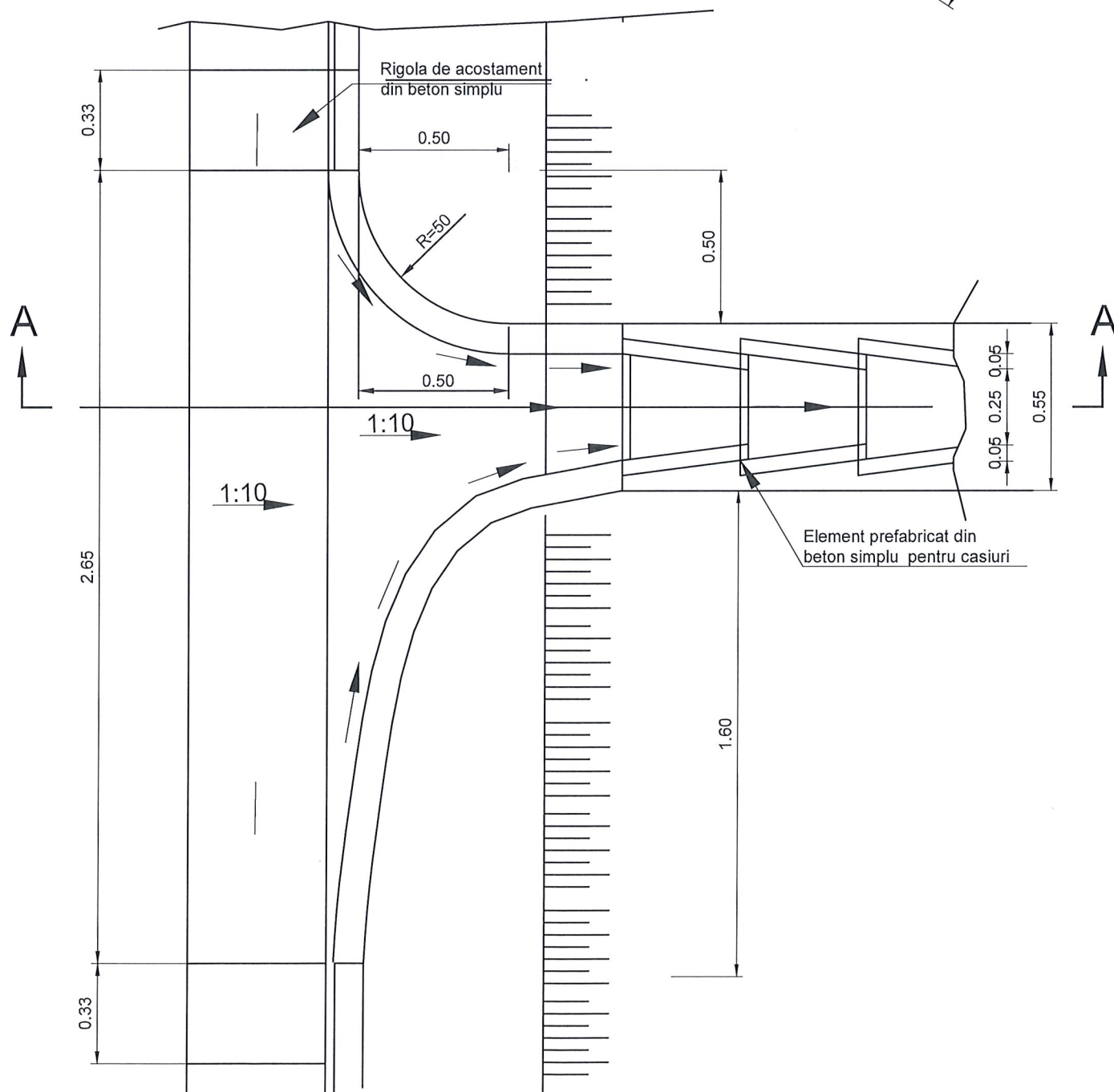

## DETALIU ELEMENT PREFABRICAT PENTRU CASIURI

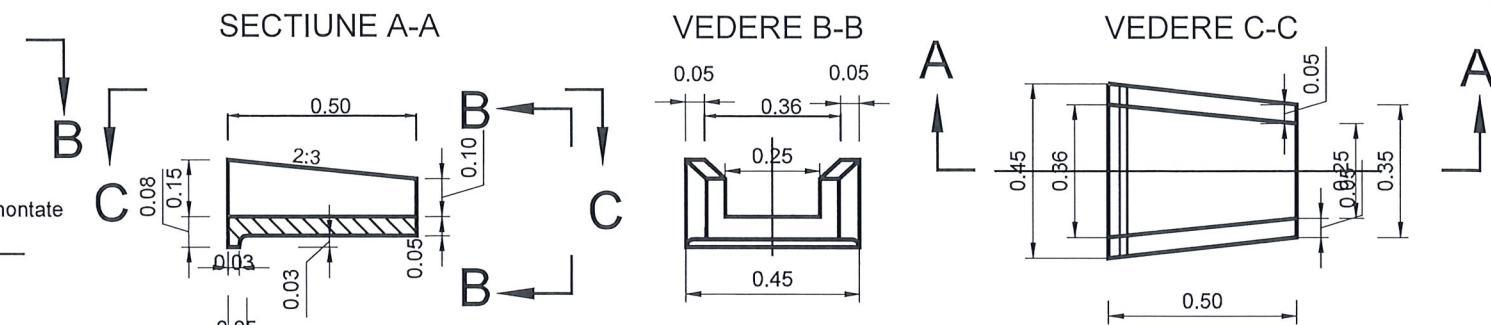

## RIGOLA DE ACOSTAMENT PREFABRICATA SAU MONOLITA



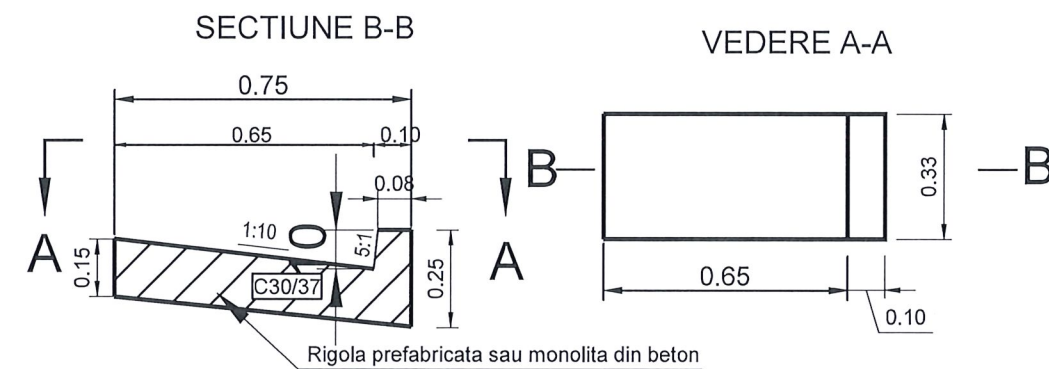
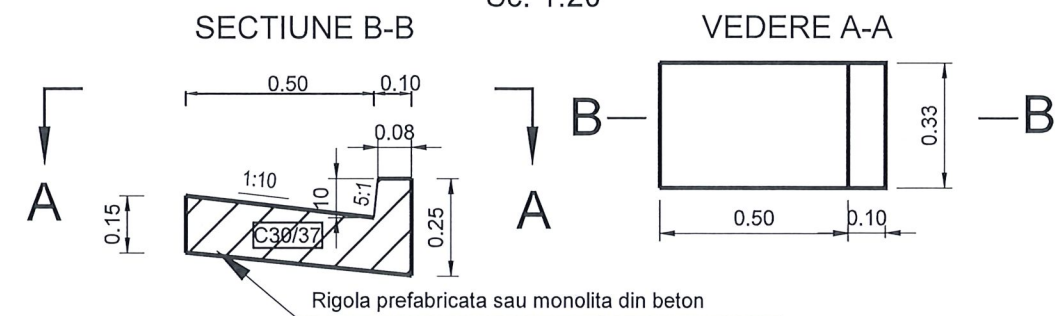

Sc. 1:20

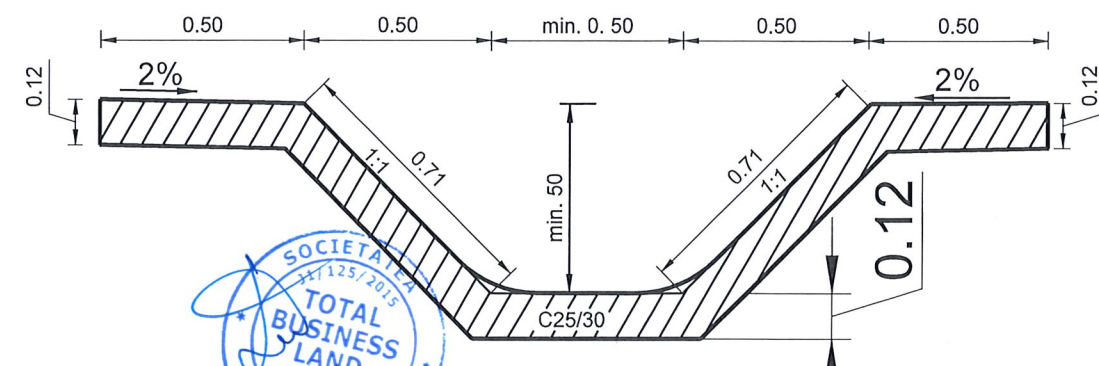

## DETALIU SANT MONOLIT DE LA BAZA RAMBLEULUI

Sc. 1:20



	Proiectant general:			Beneficiar:  MUNICIPIUL SEBES	Proiect nr.  62/20.04.2022	
	S.C. TOTAL BUSINESS LAND S.R.L.					
	Nr.ord.reg.com. J01/125/2015 C.U.I. RO34090016 ALBA IULIA, str. Brindusei nr. 24, Birou 1,jud. ALBA				Titlu proiect: „Drum de ocolire in partea de vest a Municipiului Sebes"	
					Faza: S.F.	
<div>CERTIFICAT SISTEM DE MANAGEMENT AL CALITATII ISO 9001:2015 nr.09/NAT398 ISO 14001:2015 nr.14/NAR398 SR OHSAS 18001:2008 nr.18/NAT398</div>	Specificatie	Nume	Semnatura	Scara: 1:20	Titlu planșă:  DISPOZITIVE DE SCURGERE A APELOR	Planșa nr.  DE.01-2
	Manager de proiect :	Ing. Dumitras Florian		Data: 2022		
	Sef de proiect :	dr.Ing. Radu E.E. Luca				
	Proiectant:	Ing. Dumitras Florian				
Ing. Marin Razvan						
Ing. Simona Riciu		